

**YOUR NAME**

Start the trail at the grey arrow  
Follow the numbers from 1-14.

**1 TITLE**

This is where people are baptised (or Christened) when they become members of a church. What is put into the font for a baptism?

W \_ \_ \_ \_

How many sides has the font? \_\_\_\_\_

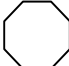
Is the font a hexagon  or an octagon? 

Tick the correct shape

**2 ROOSTER (COCKEREL)**

This is a reminder of the story that a cockerel crowed when St Peter three times denied that he knew Jesus, who had been arrested.

Draw one of the roosters

Where were the roosters before they were put into the light box?

V \_ \_ \_ \_ \_ D \_ \_ \_

**3 STATIONS OF THE CROSS**

These are a series of pictures telling the story of Jesus from his condemnation by Pilate to his Crucifixion used as an aid to prayer.

How many Stations of the Cross can you find in the church?

\_\_\_\_\_



**EAST**

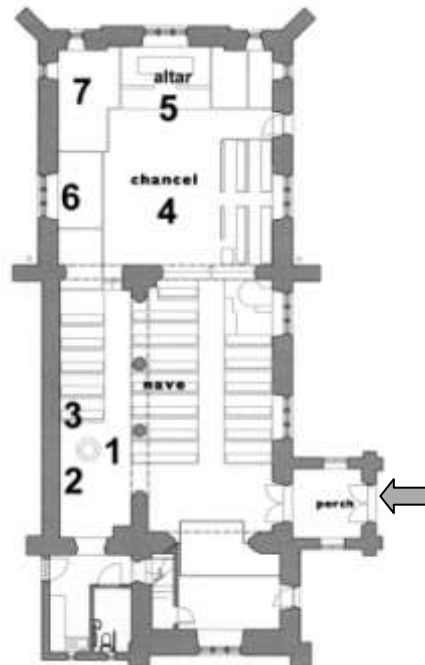

**WEST**

**4 CHANCEL**

Originally the area reserved for the clergy at the east end of the church and often divided off by a screen or steps. At one time the clergy were responsible for maintaining the chancel and the people for maintaining the rest of the church.

What separates the chancel from the aisles in the church?

S \_ \_ \_ \_ S \_ \_ \_ \_

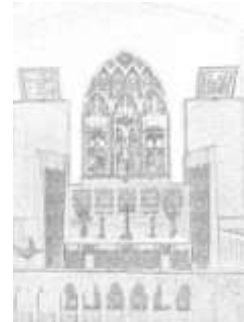

**5 ALTAR**

A table, the focal point of a church, where the main Christian act of the Eucharist (Holy Communion or Mass) is performed. It is also called "The Lord's Table", "The Holy Table" or "The Communion Table".

What can you see in the centre of the altar?

B \_ \_ \_ \_ C \_ \_ \_ \_



**6 NEW WINDOW**

As with many old stained glass windows, the new stained glass window which was installed in 2014, commemorates members of the families of the two donors.

In the window, inside a diamond shape, find the temple which is a link with Gopsall Hall.

What musical instruments can you see in the window?

V \_ \_ \_ \_ \_ L \_ \_ \_ (left panel)

L \_ \_ \_ \_ H \_ \_ \_ (right panel)

**7 BOX PEWS**

These are a type of church pew encased in panelling. Box pews provided privacy and allowed the family to sit together.

How many box pews can you see in the Chancel? \_\_\_\_\_

What can you see in the Howe family box pew in the left hand corner?

F \_ \_ \_ \_ \_

## 8 CHOIR

A choir, also sometimes called quire, is the area of a church that provides seating for the clergy and church choir. The choir in St Mary's has long benches running parallel to the walls of the church.

How many poppy finials can you see on the ends of the choir benches? \_\_\_\_\_

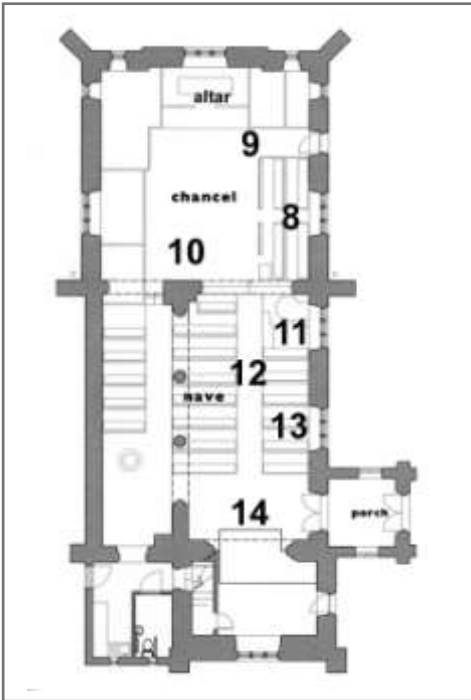
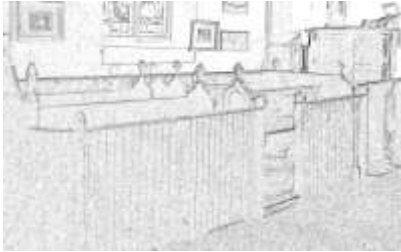

## 9 BIER

A movable frame on which a coffin is placed before burial or cremation or on which they are carried to the grave.

How many wheels has the bier? \_\_\_\_\_

How do you steer the bier? \_\_\_\_\_

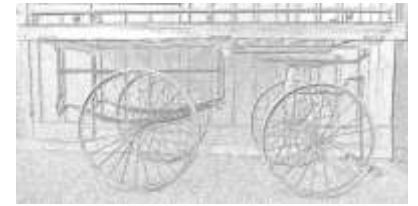

## 10 EAGLE LECTERN

A bookstand in wood or brass to hold the large Holy Bible or The Lectionary from which the lessons are read during a church service. It is shaped like an eagle with outspread wings, because eagles are thought to be the birds that can fly the highest and so nearest to the heavens. The eagle is often standing on a sphere which represents the world.

Is the eagle standing on a sphere? \_\_\_\_\_

Why do you think there is a box next to the lectern?  
\_\_\_\_\_

## 11 PULPIT

An elevated and enclosed platform from which a sermon (talk) is delivered during a service. It is raised so that the preacher can be seen and heard easily.

Who is commemorated on the brass plaque on the pulpit?

L \_ \_ \_ E \_ \_ \_ \_ \_

E \_ \_ \_

Draw a picture of the carved panels on the pulpit.

## 12 NAVE AND NORTH AISLE

The main body of the church with benches, pews or chairs for the congregation/people. Any fixed church seating is often referred to as the Pews. To be exact a pew has a door and open seating should really be referred to as Benches.

Does St Mary's have pews or benches?  
\_\_\_\_\_

Draw a picture of a poppyhead finial at the ends of the seating in the nave.

## 13 SOUTH NAVE WINDOW

The window was created by Alexander Gascoyne. We know this because his mark or logo - a winged lion with a bible - is present in the window.

Find the lion and draw it in the space.

Who are the female saints shown in the window?

S \_ M \_ \_ \_ V \_ \_ \_ \_ \_

S \_ E \_ \_ \_ \_ \_ \_ \_ S \_ A \_ \_ \_

## 14 ORGAN

The pipes which you can see are never all the pipes of the organ. The longest pipes make the lowest sounds. The organ is played using a keyboard. The pedal board is just like the keys for the hands but is played by the feet and controls deeper sounds. On either side of the keys you can see stop knobs. These control rows of pipes which make the sound higher or lower. Who installed the organ in 1914, and who does it commemorate?  
\_\_\_\_\_

Thank you for visiting St Mary's Church. We hope that you have enjoyed The Arts Society Children's Trail.