



**YOUR NAME**

Start the trail at the grey arrow  
Follow the numbers from 1-13.

**1 FONT**

The font is where baptisms (Christenings) take place.

What is put into the font for a baptism?

W \_ \_ \_ \_

How many cherubs are there?

What is the cover made of? \_\_\_\_\_

**2 DOOM PAINTING**

This wall painting shows The Day of Judgement. Circle the things you **can** see:

- |          |                 |              |
|----------|-----------------|--------------|
| Rainbow  | Cat             | Jesus Christ |
| Devil    | King with crown | Car          |
| Computer | Wheelbarrow     | Angel        |

**3 MELLISH MONUMENT**

This monument is to Edward Mellish, who built Blyth Hall.

How many swans are on the coat of arms at the top of the monument?

What other animal can you see?  
\_\_\_\_\_



**EAST**

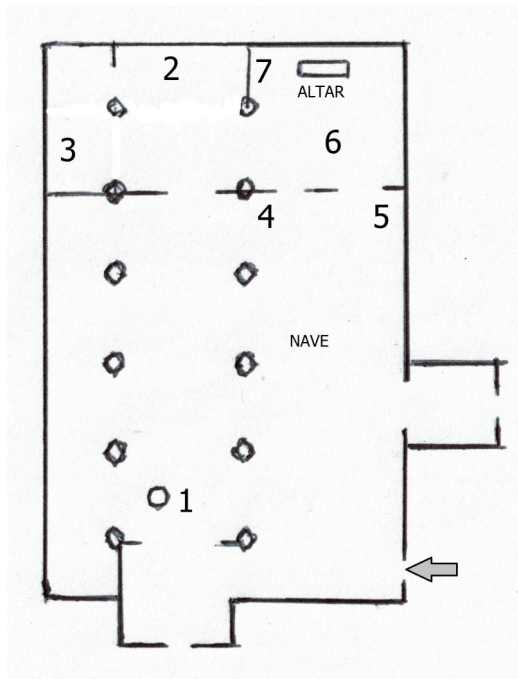

**4 PULPIT**

The minister delivers his sermon (talk) from the pulpit.

Why is it so high up?

\_\_\_\_\_  
\_\_\_\_\_  
\_\_\_\_\_



**5 CARVED LECTERN**

What is the name of the red book on the lectern?

H \_ \_ \_ B \_ \_ \_ \_

Draw the face on the lectern.

**WEST**

**7 KNIGHT EFFIGY**

Draw the helmet that the knight wears.

What is the special name of this helmet?  
\_\_\_\_\_

**6 CHANCEL**

Look at the seats in the chancel.

Who do you think sits here?

\_\_\_\_\_  
\_\_\_\_\_

See if you can spot the date carved into the wood panelling in the chancel .

**8 ALTAR**

The altar (Holy Table) is at the east end of the church.  
What colour is the cloth on it today?

\_\_\_\_\_

What is on the marble shelf behind the altar?

\_\_\_\_\_



**EAST**

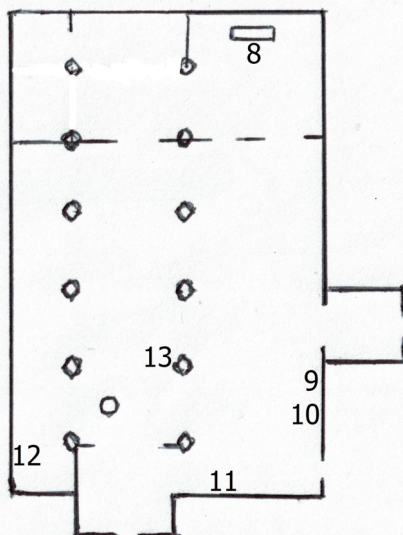

**9 LIST OF PRIORS AND VICARS**

Who was the prior in 1306?

\_\_\_\_\_  
\_\_\_\_\_

Who was the vicar in 1386?

\_\_\_\_\_  
\_\_\_\_\_



**10 SOUTH AISLE WINDOW**

This window shows scenes from Christ's life.  
Looking at the right-hand side of the window,  
who are the parents of Jesus Christ?

M \_\_\_\_\_ and J \_\_\_\_\_

Who was found in a cradle in the bullrushes?

M \_ \_ \_ \_

**11 HATCHMENTS**

The diamond-shaped panels on the west wall are hatchments belonging to the Mellish family.  
Complete the hatchment furthest to your left.

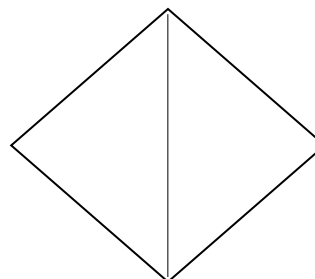

**12 BENEFACTORS BOARDS**

Who left £20 to "poor widows of Blyth"?

\_\_\_\_\_

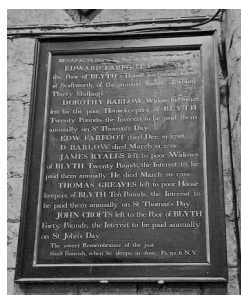

**13 POOR BOX**

What do you think the poor box was used for?

\_\_\_\_\_

Why are there locks on it?

\_\_\_\_\_  
\_\_\_\_\_

**ENDPIECE**

Well done! You have now finished the Children's Trail. We hope you enjoyed discovering some of the history of St Mary & St Martin's Church. Perhaps you might like to bring family and friends to visit the church. Sit down for a while and think about all the people who have visited this church for hundreds of years. Write a sentence below to describe your feelings about this building.

\_\_\_\_\_